

# ELKAY<sup>®</sup>

## SPECIFICATIONS

### Sink Accessories

#### Models LKS35 Series Drain and LKD35 Series Disposer Flange Fitting

#### GENERAL

**LKS35** Polymer drain outlet fitting with removable basket strainer. Designed to fit 3-1/2" (89mm) drain opening with an overall flange size of 4-1/2" (114mm).

Max sink thickness: 1-1/4" (32mm).

**LKD35** Polymer disposer flange fitting with removable basket strainer. Designed to snap over garbage disposal drain bodies that use a three bolt mounting bracket. Overall flange size is 4-1/2" (114mm).

#### MODEL COLOR

LKS35BK	Black
LKS35BQ	Bisque
LKS35MC	Mocha
LKS35WH	White
LKD35BK	Black
LKD35BQ	Bisque
LKD35MC	Mocha
LKD35WH	White

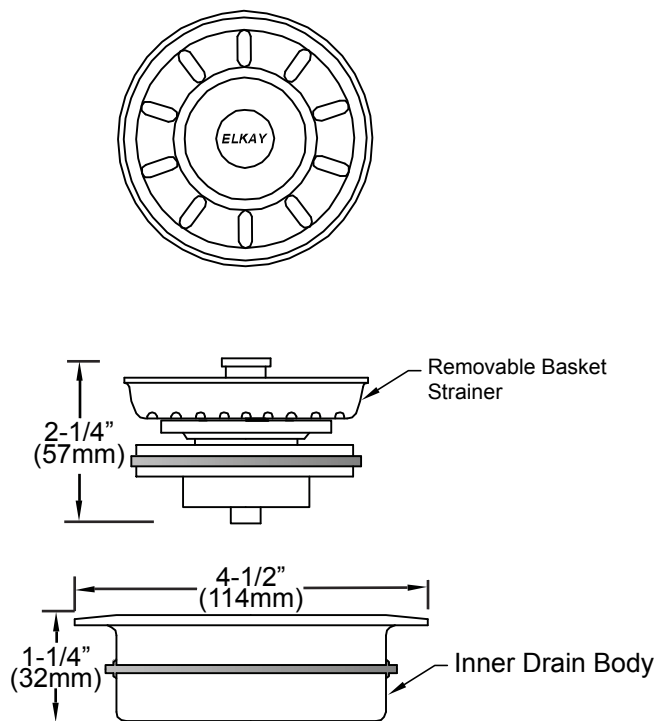

Model LKD35 Series Illustrated

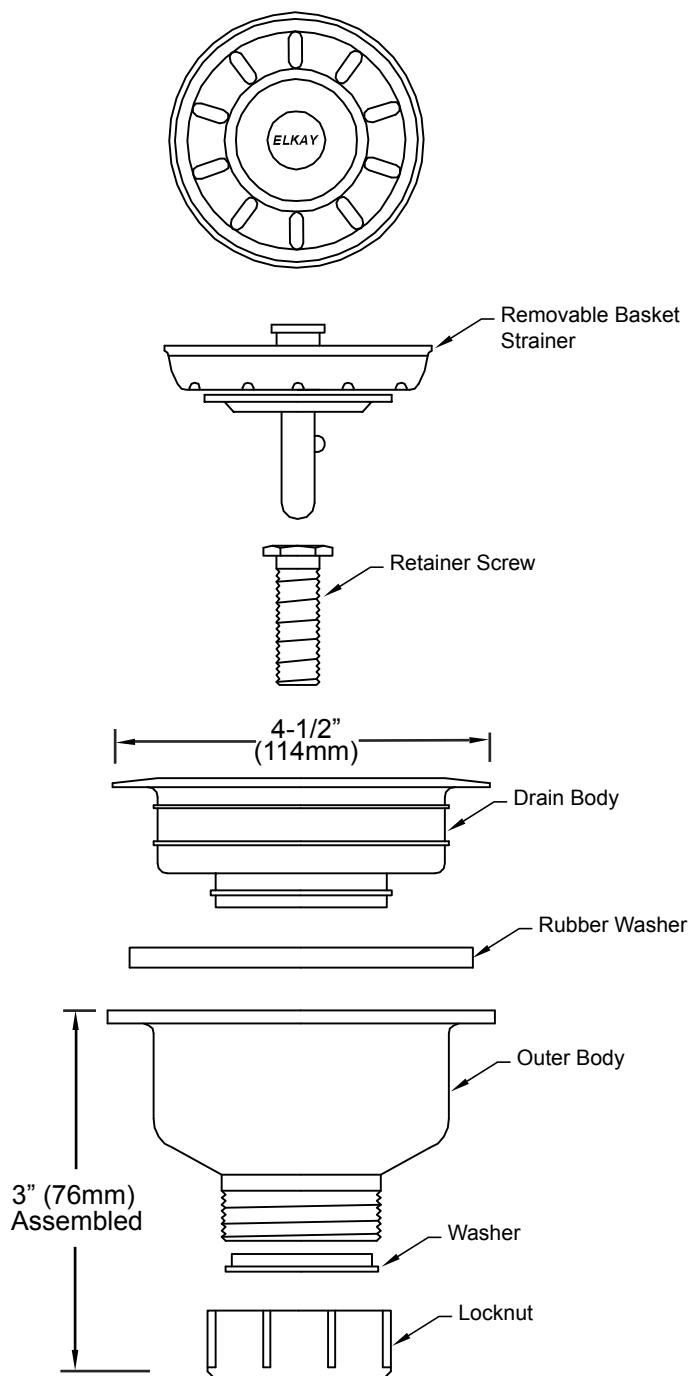

Model LKS35 Series Illustrated

In keeping with our policy of continuing product improvement, Elkay reserves the right to change product specifications without notice.

This specification describes an Elkay product with design, quality and functional benefits to the user. When making a comparison of other producers' offerings, be certain these features are not overlooked.