

FEATURES**Model LK500HA10L2**

- One hole dual handle top mount faucet
- Quarter turn ceramic disc cartridge
- Solid brass construction
- Chrome finish
- Includes spout swing restriction pin

Model LK500HA10T4

- Same as LK500HA10L2 except with 4" wrist blades handles

Model LK500HA10T6

- Same as LK500HA10L2 except with 6" wrist blades handles

COMPLIES WITH:

- ASME/ANSI A112.18.1
- CSA B125-01
- NSF/ANSI 61
- ADA
- UPC/CUPC
- IAPMO Listed

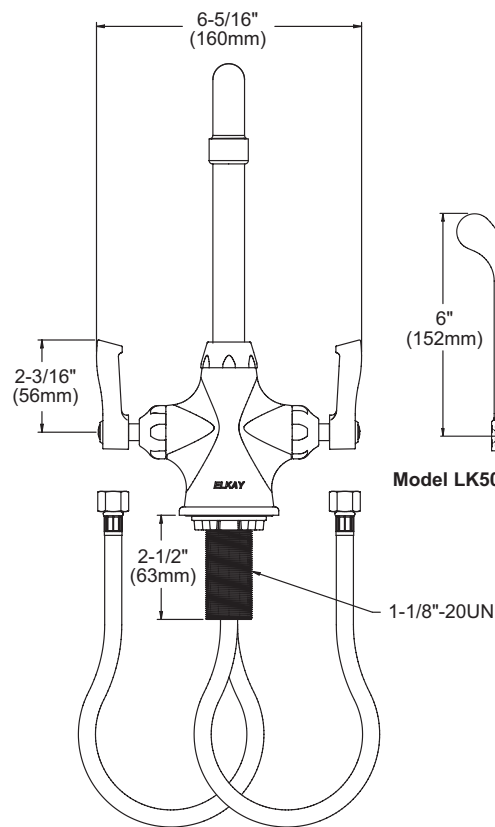
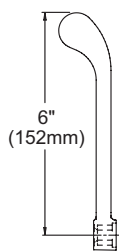
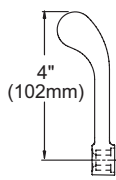
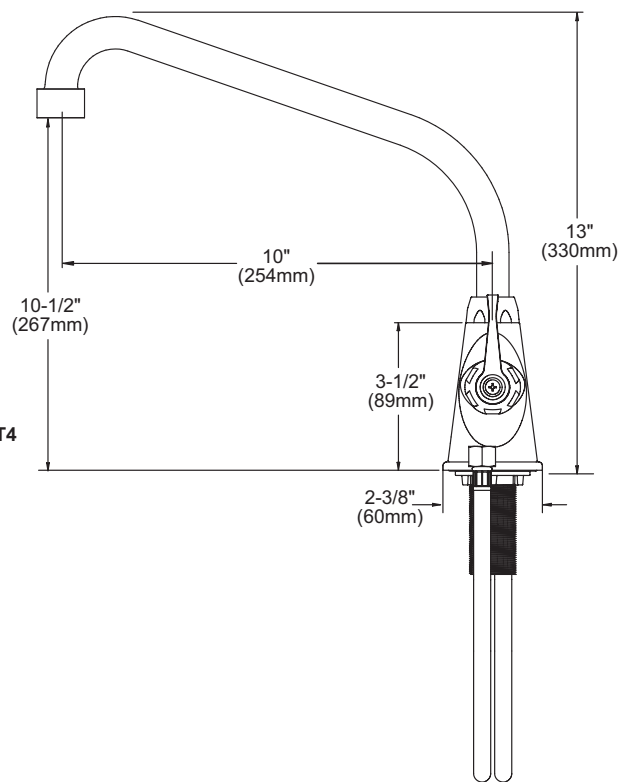
**Concealed Deck Commercial Faucet
Models LK500HA10L2, LK500HA10T4, LK500HA10T6****Model LK500HA10L2****FRONT VIEW****Model LK500HA10T6****Model LK500HA10T4****SIDE VIEW****Job Name:****Item #:****Notes:****Architect/Engineer Approval:****Date:**

SEE OTHER SIDE FOR REPLACEMENT PARTS

Concealed Deck Commercial Faucet Models LK500HA10L2, LK500HA10T4, LK500HA10T6

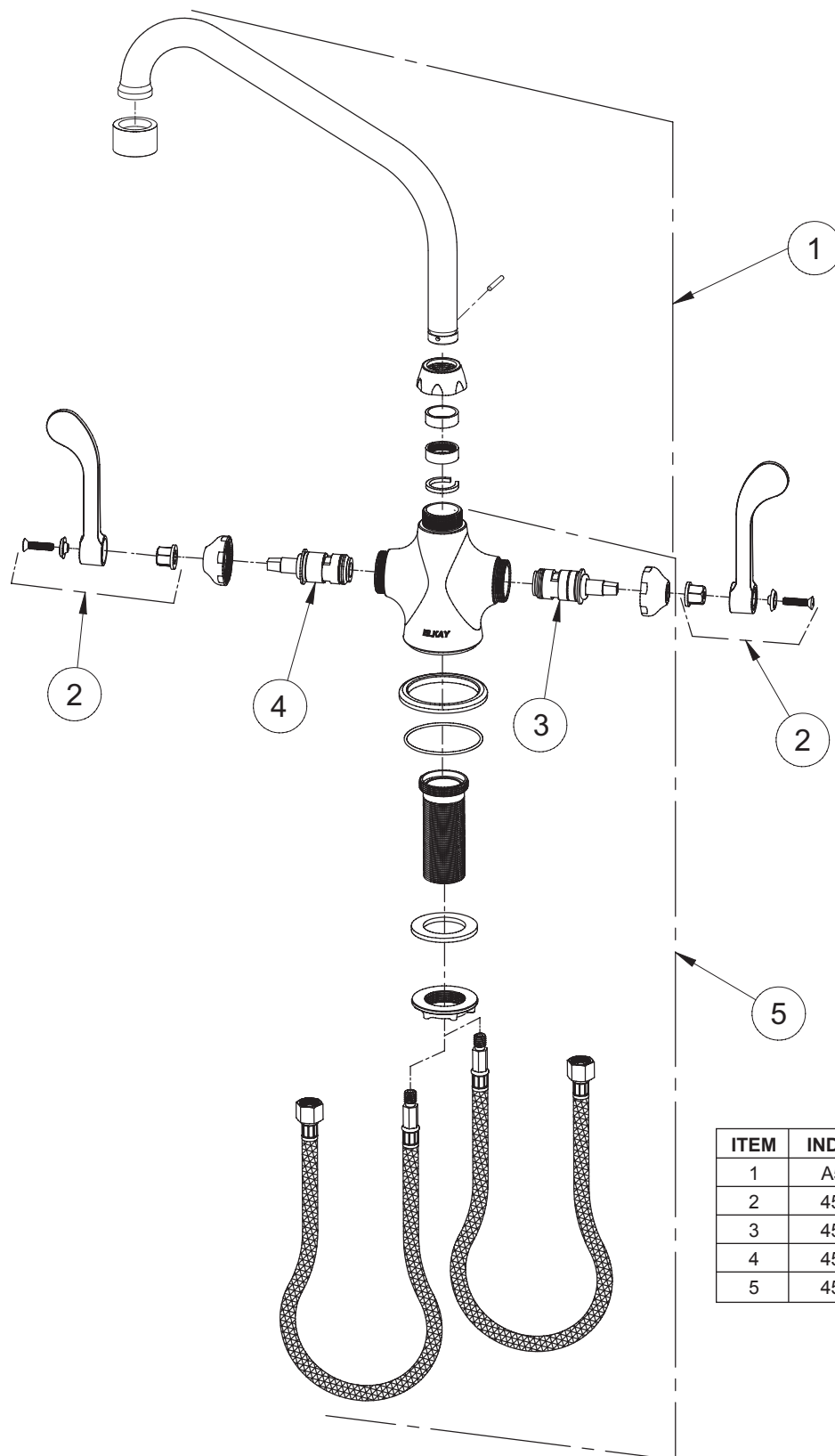

ITEM	IND. PART	DESCRIPTION
1	A55393	Spout
2	45918C	Handle
3	45923C	Right Cold Cartridge
4	45924C	Left Hot Cartridge
5	45917C	Body