

FEATURES**Model LK940BP03L2S**

- Two hole dual handle wall mount faucet
- Quarter turn ceramic disc cartridge
- 1/2" adjustable inlets with integral stops
- Solid brass construction
- Chrome finish
- Includes spout swing restriction pin

Model LK940BP03T4S

- Same as LK940BP03L2S except with 4" wrist blades handles

Model LK940BP03T6S

- Same as LK940BP03L2S except with 6" wrist blades handles

COMPLIES WITH:

- ASME/ANSI A112.18.1
- CSA B125-01
- NSF/ANSI 61
- ADA
- UPC/CUPC
- IAPMO Listed

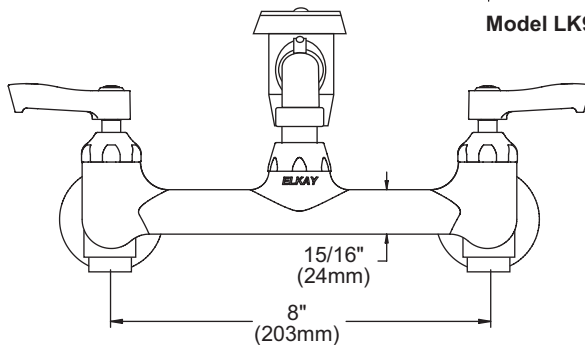
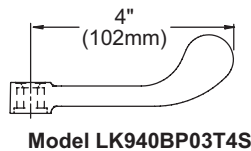
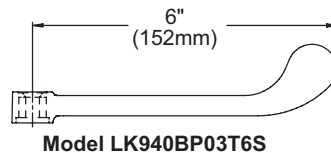
**Wall Mount 8" Center Commercial Faucet
Models LK940BP03L2S, LK940BP03T4S, LK940BP03T6S**

Model LK940BP03L2S
FRONT VIEW

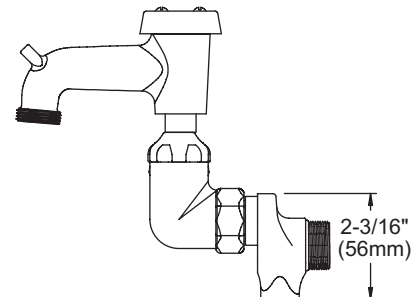

SIDE VIEW

Job Name:	Item #:
Notes:	
Architect/Engineer Approval:	Date:

SEE OTHER SIDE FOR REPLACEMENT PARTS

Wall Mount 8" Center Commercial Faucet
Models LK940BP03L2S, LK940BP03T4S, LK940BP03T6S

