

FEATURES

Model LK940BP07L2S

- Two hole dual handle wall mount faucet
- Quarter turn ceramic disc cartridge
- 1/2" adjustable inlets
- Solid brass construction
- Chrome finish
- Includes spout swing restriction pin

Model LK940BP07T4S

- Same as LK940BP07L2S except with 4" wrist blades handles

Model LK940BP07T6S

- Same as LK940BP07L2S except with 6" wrist blades handles

COMPLIES WITH:

- ASME/ANSI A112.18.1
- CSA B125-01
- NSF/ANSI 61
- ADA
- UPC/CUPC
- IAPMO Listed

Wall Mount 8" Center Commercial Faucet Models LK940BP07L2S, LK940BP07T4S, LK940BP07T6S

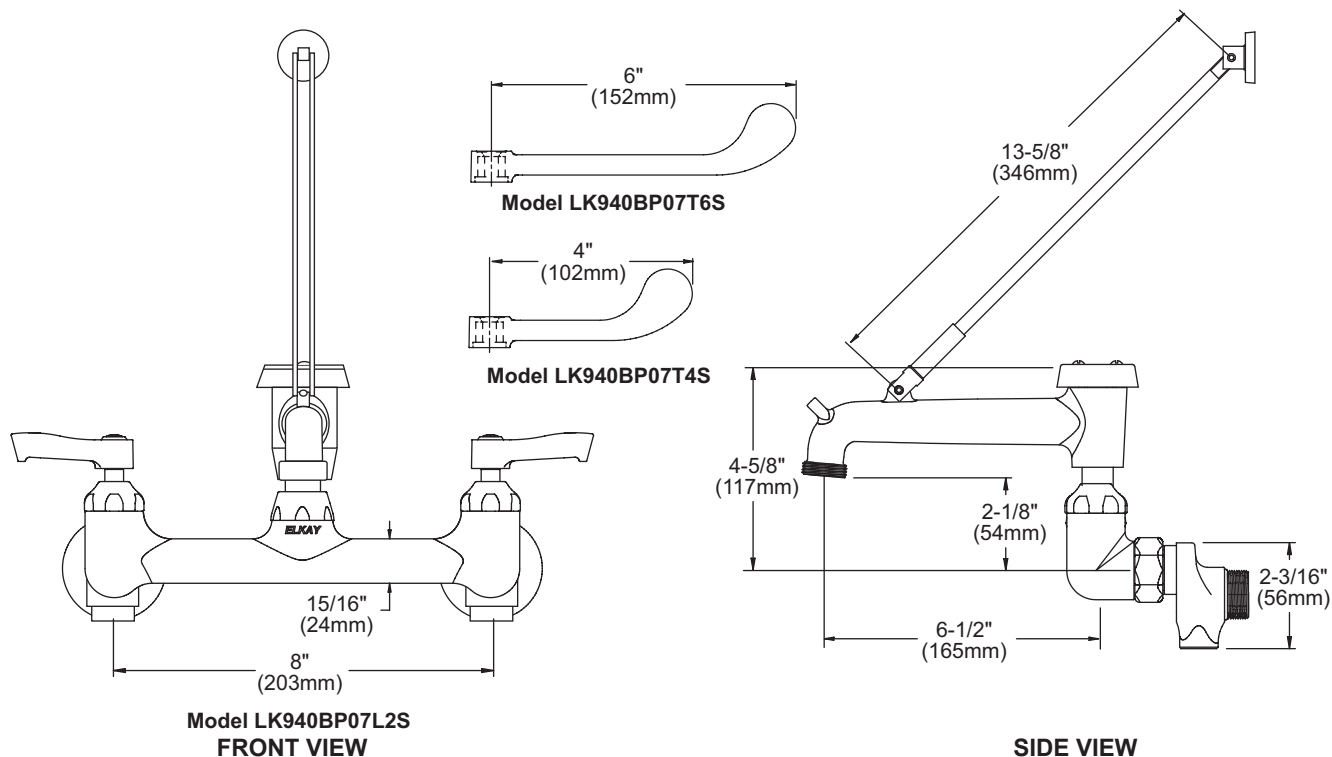

Job Name:

Item #:

Notes:

Architect/Engineer Approval:

Date:

SEE OTHER SIDE FOR REPLACEMENT PARTS

Wall Mount 8" Center Commercial Faucet
Models LK940BP07L2S, LK940BP07T4S, LK940BP07T6S

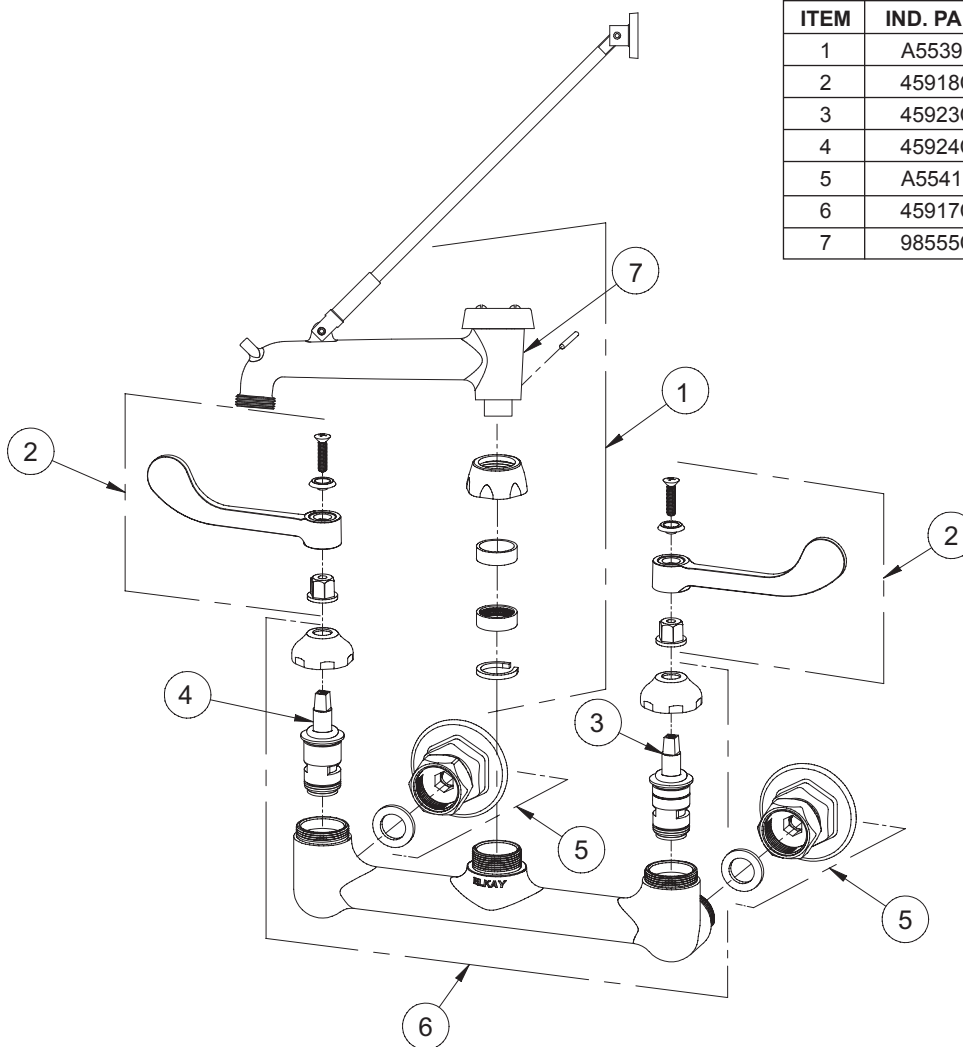

ITEM	IND. PART	DESCRIPTION
1	A55393	Spout
2	45918C	Handle
3	45923C	Right Cold Cartridge
4	45924C	Left Hot Cartridge
5	A55413	2" Adjustable Inlet
6	45917C	Body
7	98555C	V.B. Repair Kit